

DISCOVER PUERTO RICO

MEETINGS + CONVENTIONS 2021



PUERTO RICO'S OFFICIAL MEETING PLANNING GUIDE

DISCOVER
Puerto Rico

IT'S TIME TO PLAN FOR PUERTO RICO!

Your attendees will explore turquoise deep dives, non-virtual happy hours and safe ways to connect. And with numerous ways to meet with our beaches, mountains and rainforest as your backdrop, planning a meeting in Puerto Rico will be as stress-free as our Island. As a U.S. territory, Puerto Rico offers the allure of an exotic locale with a rich, vibrant culture, without needing a passport or currency exchange. Accessibility to the Island has never been easier, with direct flights from domestic locations like New York, Charlotte, Dallas and Atlanta, to name a few.

Outdoor options will continue to be an attractive alternative. Home to one of the world's largest dry forests, the only tropical rainforest in the U.S. National Forest System, hundreds of underground caves, 18 golf courses and so much more, Puerto Rico delivers profound outdoor experiences, like kayaking the iridescent Bioluminescent Bay or zip lining through a canopy of emerald green to the sound of native coquí tree frogs.

The highly anticipated Distrito T-Mobile, opening this year in our convention center district, is an exciting new entertainment option. With an exhilarating urban zipline, large high-tech open air plaza and numerous restaurants and bars offering authentic food, music, beer and rum – your attendees will become immersed in the local flavors and colorful music and art of our Island when your meetings are finished each day.

We'll welcome you with genuine, warm Island hospitality. Take an exotic departure with your next meeting or event in Puerto Rico, the only US destination offering an international experience, without the need for a passport. Find out more at DiscoverPuertoRico.com/meetings.



@MeetingsInPR



MeetingsInPR



Discover Puerto Rico



/discoverpuertorico



WHAT'S INSIDE

WHY PUERTO RICO?	4
CULINARY AND COCKTAILS	5
GETTING HERE	6
GETTING AROUND	7
MAPS	8-9
HOTELS	10-11
PUERTO RICO CONVENTION CENTER	12-17
CULTURE AND ATTRACTIONS	18
GOLF AND OUTDOOR ADVENTURES	19
VENUES	20-21
CONNECT WITH OUR SALES TEAM	22-25

WHY PUERTO RICO?

AMPLE AIRLIFT AND STATE OF THE
ART AIRPORT FACILITIES

THE CULTURAL EXPERIENCE OF AN
INTERNATIONAL DESTINATION, CLOSE
TO HOME

NO PASSPORT REQUIRED FOR U.S.
TRAVELERS

NO NEED FOR INTERNATIONAL
MOBILE PLAN OR CURRENCY
CONVERSION FOR U.S. TRAVELERS

ENGLISH & SPANISH SPOKEN WIDELY
ACROSS THE ISLAND

HOSPITABLE AND FRIENDLY PEOPLE

A CONVENTION CENTER DISTRICT
FEATURING NEW AND RENOVATED
HOTELS, AUTHENTIC ENTERTAINMENT
AND DINING OPTIONS AND A HIGH-
TECH CONVENTION CENTER WITH
600,000 TOTAL SQUARE FEET OF
MEETING SPACE.

WARM WEATHER ALL YEAR
(85° F AVERAGE)

4 PIÑONES
LOÍZA, PUERTO RICO



PUNTA HIGÜERA LIGHTHOUSE
RINCÓN, PUERTO RICO



LA PERLA
OLD SAN JUAN, PUERTO RICO



CONDADO VANDERBILT HOTEL
SAN JUAN, PUERTO RICO



COPAMARINA BEACH RESORT & SPA
GUÁNICA, PUERTO RICO



CUATRO SOMBRAS CAFE
SAN JUAN, PUERTO RICO

CULINARY AND COCKTAILS

With endless evolution and constant transformation, Puerto Rico has evolved into a “foodie paradise”, incorporating many different influences and traditions.

Combining traditional and trendy flavors, merging international and local cuisine, and reinventing those abuelita recipes, our chefs will take your attendees on a wonderful journey of flavors and experiences.

The Island’s cocktail scene has evolved with equal care. Puerto Rico is the birthplace of the piña colada, and you’ll find that an innovative approach to refreshing drinks continues to this day.

Whether it’s one of the world’s top bars in Old San Juan, a mixology class, a tasting of local rums, or a poolside cocktail, your group find numerous ways to experience our unique cocktail culture.

GETTING HERE

AIRPORTS

- San Juan (SJU): Luis Muñoz Marín International Airport
- Aguadilla (BQN): Rafael Hernández Airport
- Ponce (PSE): Mercedita Airport
- Vieques (VQS): Antonio Rivera Rodríguez Airport
- Culebra (CPX): Aeropuerto Benjamín Rivera Noriega

AIRLINES

American Airlines, Delta Air Lines, Frontier Airlines, United Airlines, JetBlue Airways, Spirit Airlines, Southwest Airlines, Sun Country Airlines, Cape Air, and Silver Airways.

EASY AIR ACCESS FROM MAJOR CITIES

DEPARTURE	ARRIVAL	TIME APPROXIMATION	STOPS
Atlanta/ATL	SJU	3hrs 25 mins	
Baltimore/BWI	SJU	3hrs 37 mins	
Boston/BOS	SJU	3hrs 56 mins	
Charlotte/CLT	SJU	3hrs 50 mins	
Chicago/ORD	SJU	4hrs 4 mins	
Dallas/DFW	SJU	4hrs 45 mins	
DC/BWI	SJU	3hrs 37 mins	
Denver/DEN	SJU	7 hrs	1
Detroit /DTW	SJU	4hrs 20 mins	
Los Angeles/LAX	SJU	7hrs 43 mins	1
Miami/MIA	SJU	2hrs 35 mins	
Minneapolis/MSP	SJU	5hrs 18 mins	
NYC/JFK	SJU	3hrs 40 mins	
Orlando/MCO	SJU	2hrs 45 mins	
Philadelphia/PHL	SJU	3hrs 50 mins	1
San Francisco/SFO	SJU	8hrs 49 mins	1
Seattle/SEA	SJU	8hrs 43 mins	1
St. Louis/ STL	SJU	7 hrs	1

We recommend reaching out to our team meetings@DiscoverPuertoRico.com for assistance with the latest information on airlift, hotels, health & safety guidelines.

Find out more at DiscoverPuertoRico.com/meetings or follow our social channels at:



@MeetingsInPR



MeetingsInPR



Discover Puerto Rico



/discoverpuertorico

GETTING AROUND

Getting around our Island is easy with the following options:

TRANSPORTATION FROM AIRPORT

- Taxis
- Rental Cars (see below)
- Hotel Shuttles
- Rideshare Options
- Public Transportation

RENTAL CARS

If you're planning to be on our Island for over three days and want to venture outside the metropolitan area, renting a car is more practical. There are 14 companies for you to choose from between major car rental companies and smaller local companies.

RIDESHARE

Readily available in all main touristic zones, and to and from the airport.

TAXIS

Cabs and shuttles are often found outside the main exits of tourist attractions or at the front doors of most hotels. You can either hail for a taxi or call one to come pick you up.

CHARTERING COACHES

There are several companies that charter coaches, minibuses and vans. For information on transportation companies, please visit our website: <https://www.discoverpuertorico.com/transportation>.

MAPS

SAN JUAN METRO HOTEL MAP



We recommend reaching out to our team meetings@DiscoverPuertoRico.com for assistance with the latest information on airlift, hotels, health & safety guidelines. Find out more at DiscoverPuertoRico.com/meetings or follow our social channels at:



@MeetingsInPR



MeetingsInPR



Discover Puerto Rico



/discoverpuertorico

EAST REGION LODGING MAP

*Properties with 1,000 sq. ft or more of meeting space



	HOTELS	LOCATION
①	Four Points by Sheraton Caguas Real Hotel & Casino	Caguas
②	Wyndham Grand Río Mar Puerto Rico Golf & Beach Resort	Río Grande
③	The St. Regis Bahía Beach Resort	Río Grande
④	Hyatt Regency Grand Reserve	Río Grande
⑤	El Conquistador Resort	Fajardo
⑥	Wyndham Candellero Beach Resort	Humacao

	TRANSPORTATION	LOCATION
	Ferry Terminal	Ceiba
	Ferry Terminal	Vieques
	Ferry Terminal	Culebra
	Benjamin Rivera Noriega Airport	Culebra (CPX)
	Antonio Rivera Rodríguez Airport	Vieques (VQS)

WEST REGION LODGING MAP

	FACILITY	STATUS AS OF 06-22-2020	MUNICIPALITY	ROOMS TOTAL	DISTANCE ESTADIO CENTRO AMERICANO DE MAYAGÜEZ
①	Parador El Faro	Open	Aguadilla	75	30 km
②	Rincón Beach Resort	Open	Añasco	118	16.8 km
③	Copamarina Beach Resort & Spa	Open	Guánica	127	49 km
④	Parador Guanica 1929	Open	Guánica	27	45.9 km
⑤	Royal Isabela	Open	Isabela	20	50 km
⑥	Parguera Plaza Hotel	Open	Lajas	30	32.4 km
⑦	Mayaguez Resort & Casino	Open	Mayagüez	140	4.6 km
⑧	Holiday Inn Mayaguez Resort & Tropical Casino	Open	Mayagüez	141	6.4 km
⑨	Mayaguez Plaza Hotel, SureStay Collection by Best Western	Open	Mayagüez	47	3.1 km
⑩	Posada Hotel Colonial	Open	Mayagüez	29	3.2 km
⑪	Hotel Guajataca	Open	Quebradillas	38	52.5 km

Availability: 25 Rooms or more

Estadio Centro Americano de Mayagüez

Aeropuerto Internacional Rafael Hernández



HOTELS

WITH 1,000+ SQUARE FEET
OF MEETING SPACE

	GUEST ROOMS	SUITES	MEETING ROOMS	TOTAL MTG SPACE	LARGEST MTG ROOM	CAPACITY (THEATRE)
CONDADO						
Caribe Hilton	652	96	28	65000	11748	1340
Best Western Condado Palm	151	33	2	1875	1560	116
Condado Vanderbilt Hotel	317	106	6	25000	8100	636
Doubletree by Hilton San Juan	184	N/A	5	5860	3600	180
La Concha A Renaissance Resort	483	204	6	25000	5576	610
San Juan Marriott Resort & Stellaris Casino	527	14	14	14000	7000	800
Condado Ocean Club	96	N/A	3	6475	2184	80
The Condado Plaza Hilton	571	62	14	47000	13000	11000
AC Marriott San Juan	233	46	7	14606	2100	140
ISLA VERDE						
Courtyard by Marriott Isla Verde Beach Resort	260	22	5	7000	2414	200
Fairmont El San Juan Hotel	388	84	13	40000	11000	1222
Embassy Suites San Juan Hotel & Casino	313	301	9	12000	4370	500
Royal Sonesta San Juan	398	22	18	24000	6042	600
The Ritz Carlton, San Juan	416	12	14	27457	11840	760
Verdanza Hotel	222	9	8	16000	3922	400
OLD SAN JUAN						
Hotel El Convento	80	9	5	6955	2772	150
Sheraton Old San Juan Hotel	240	42	9	9114	2695	250

We recommend reaching out to our team meetings@DiscoverPuertoRico.com for assistance with the latest information on airlift, hotels, health & safety guidelines.

Find out more at DiscoverPuertoRico.com/meetings or follow our social channels at:



@MeetingsInPR



MeetingsInPR



Discover Puerto Rico



/discoverpuertorico

	GUEST ROOMS	SUITES	MEETING ROOMS	TOTAL MTG SPACE	LARGEST MTG ROOM	CAPACITY (THEATRE)
PRCC DISTRICT						
Hyatt House San Juan	126	99	1	900	900	50
Hyatt Place San Juan	149	3	1	2889	2889	250
Sheraton Puerto Rico Hotel & Casino	503	22	21	35000	16000	1900
Courtyard by Marriott San Juan Miramar	135	10	2	840	420	40
Aloft Hotel <small>*Less than 1,000 square feet of meeting space, but it's next to the PRCC.</small>	175	2	4	6,000	3,524	300
BAYAMÓN						
Hyatt Place Bayamón	156	5	2	1967	1967	120
San Miguel Plaza Hotel	44	4	2	1400	900	100
FAJARDO						
El Conquistador Resort	745	17	41	100000	20486	2320
Fajardo Inn	127	20	3	5992	4000	160
RÍO GRANDE						
Hyatt Regency Grand Reserve Puerto Rico	579	99	14	31308	11946	1200
St. Regis Bahía Beach Resort Puerto Rico	139	35	7	8972	4662	420
Wyndham Grand Río Mar Puerto Rico Golf & Beach Resort	400	39	24	48000	20913	3302
CAGUAS						
Four Points by Sheraton Caguas Real Hotel & Casino	125	33	9	9746	1950	200
MAYAGÜEZ						
Holiday Inn Mayagüez Resort & Tropical Casino	141	4	3	3747	3747	250
Mayagüez Resort & Casino	140	N/A	6	13733	9204	850
RINCÓN						
Rincon Beach Resort	112	24	4	4750	3384	300
AGUADILLA						
Courtyard by Marriott Aguadilla	145	7	5	3785	3785	275
PONCE						
Aloft Ponce	143	9	5	5,041	3,835	300
Hilton Ponce Golf & Casino Resort	255	15	18	24000	12000	1200
Holiday Inn Tropical Casino Ponce	116	6	2	1240	1240	80
Howard Johnson Hotel Ponce	120	3	2	2552	1952	120
Ponce Plaza Hotel & Casino	69	16	2	3800	3800	200
DORADO						
Dorado Beach, A Ritz Carlton Reserve	100	14	4	10358	4558	500
Embassy Suites by Hilton Dorado del Mar Beach Resort	N/A	174	10	22000	8369	1000
MANATÍ						
Hyatt Place Manatí	104	3	2	1965	1965	140

PUERTO RICO CONVENTION CENTER

- ASM Global managed facility
- VenueShield, a comprehensive, best-in-class hygiene program
- GBAC Star Rated Facility
- Hybrid meeting capabilities





PUERTO RICO CONVENTION CENTER
SAN JUAN, PUERTO RICO

MEETING SPACE

LEVEL ONE - EXHIBIT HALL

	FEET OR SQUARE FEET				METER OR SQUARE METERS				BOOTH	SEATING CAPACITIES			
	Area	Length	Width	Height	Area	Length	Width	Height		10' X 10'	Theater	Banquet	Classroom
Exhibition Hall (Total)	152,700	268	574	30	14,186	81.7	175	9.1	794	16,576	7,560	7,605	12,000
Exhibit Hall A	40,500	268	152	30	3,763	81.7	46.3	9.1	210	4,020	1,980	2,145	3,500
Exhibit Hall B	71,300	268	270	30	6,624	81.7	82.3	9.1	372	6,510	3,600	3,315	6,500
Exhibit Hall C	40,900	268	152	30	3,800	81.7	46.3	9.1	212	4,140	1,800	2,145	3,500
Meeting Rooms (Total)	14,900	-	-	-	1,384	-	-	-	-	-	-	-	-
Meeting Rm 101 (Total)	3,200	60	60	16	297	18.3	18.3	4.9	16	334	160	160	336
101-A	1,600	59	30	16	149	18	9.1	4.9	8	156	80	99	168
101-B	1,600	61	30	16	149	18.6	9.1	4.9	8	156	80	9	168
Meeting Rm 102 (Total)	3,818	49	89	16	355	14.9	27.1	4.9	18	353	200	198	400
102-A	1,300	47	29	16	121	14.3	8.8	4.9	5	112	60	81	137
102-B	1,300	49	30	16	121	14.9	9.1	4.9	6	121	60	81	137
102-C	1,200	51	30	16	111	15.5	9.1	4.9	7	102	50	58	126
Meeting Rm 103 (Total)	3,100	60	58	16	288	18.3	17.7	4.9	18	344	200	186	337
103-A	1,500	60	30	16	139	18.3	9.1	4.9	9	172	80	93	168
103-B	1,600	60	28	16	149	18.3	8.5	4.9	9	172	80	93	169
Meeting Rm 104 (Total)	4,800	60	90	16	446	18.3	27.4	4.9	22	456	280	260	505
104-A	1,500	60	31	16	139	18.3	9.4	4.9	7	156	80	99	158
104-B	1,700	60	30	16	158	18.3	9.1	4.9	7	156	80	99	179
104-C	1,600	60	30	16	149	18.3	9.1	4.9	8	156	80	99	168
Conference Room	546	-	-	-	51	-	-	-	30PPL	50	20	30	50
Concourses	9,564	-	-	-	889	-	-	-	-	-	-	-	-
Prefunction	4,826	-	-	-	448	-	-	-	-	-	-	-	-

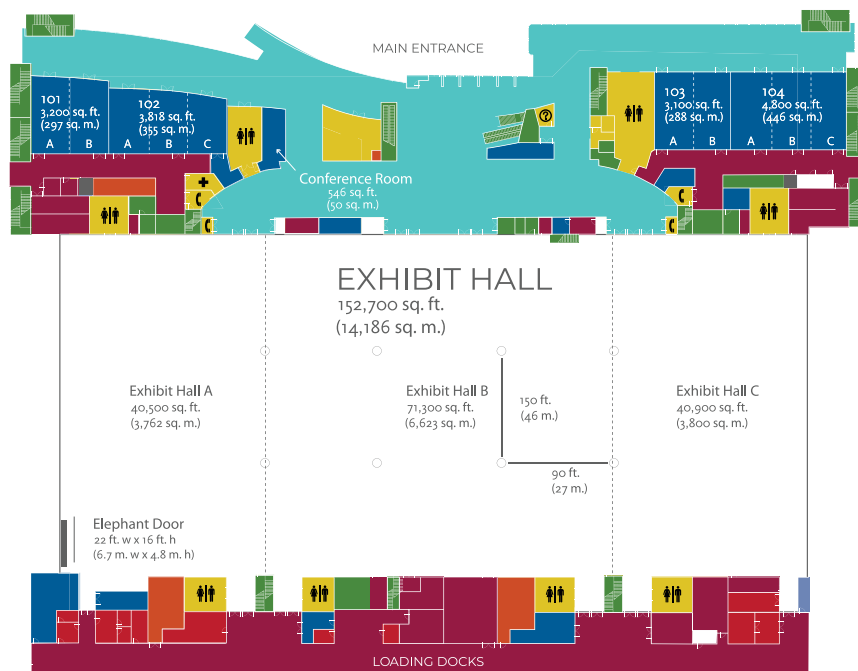

LEVEL TWO - MEETING ROOMS

	FEET OR SQUARE FEET				METER OR SQUARE METERS				BOOTH	SEATING CAPACITIES			
	Area	Length	Width	Height	Area	Length	Width	Height		8' x 10'	Theater	Banquet	Classroom
Meeting Rooms (Total)	22,687	-	-	-	2,108	183	17.7	4.9	-	-	-	-	-
Meeting Rm 201 (Total)	3,200	60	58	16	297	17.7	8.8	4.9	16	288	160	190	336
201-A	1,600	58	29	16	149	17.7	8.8	4.9	8	144	80	90	168
201-B	1,600	58	29	16	149	14.9	25.6	4.9	8	144	80	90	168
Meeting Rm 2012 (Total)	3,600	49	84	16	334	14.3	7.6	4.9	12	328	180	200	389
201-A	1,300	47	25	16	121	14.3	7.6	4.9	6	126	60	84	137
202-B	1,300	47	25	16	121	15.5	8.8	4.9	5	126	60	84	137
202-C	1,000	51	29	16	93	13.7	9.6	4.6	3	105	50	56	115
Meeting Rm 203	1,400	45	32	15	130	14	9.6	4.6	7	147	70	80	147
Meeting Rm 204	1,400	46	32	15	130	8.2	5.5	4.6	7	150	90	96	147
Meeting Rm 205	450	27	18	15	42	9.1	9.1	4.6	-	38	20	30	40
Meeting Rm 206	800	30	30	15	74	8.2	11.9	4.6	-	72	40	49	84
Meeting Rm 207	1,100	27	39	15	102	18.3	28.7	4.9	-	106	60	60	116
Meeting Rm 208 (Total)	4,900	60	94	16	455	18.3	8.8	4.9	22	600	280	327	516
208-A	1,600	60	29	16	149	18.3	8.8	4.9	9	158	80	99	168
208-B	1,700	60	29	16	158	18.3	9.1	4.9	8	169	80	99	180
208-C	1,600	60	30	16	149	18.3	27.4	4.9	8	169	80	99	168
Meeting Rm 209 (Total)	4,900	60	89	16	455	18.3	9.1	4.9	22	441	280	315	516
209-A	1,600	60	30	16	149	18.3	9.4	4.9	8	156	80	99	168
209-B	1,700	60	31	16	158	18.3	9.1	4.9	7	156	80	99	180
209-C	1,600	60	30	16	149	18.3	5.5	4.9	8	156	80	99	168
Meeting Rm 210	400	29	18	15	37	9	5.5	4.6	-	50	20	27	35
Meeting RM 211	537	32	18	15	50	9	28.3	4.6	-	50	20	27	50
Mezzanine Suite	3,966	42	93	-	368	12.8	-	-	-	320	180	195	400
Concourses	21,763	-	-	-	2,022	-	-	-	-	-	-	-	-
Prefunction	5,123	-	-	-	476	-	-	-	-	320	-	-	400

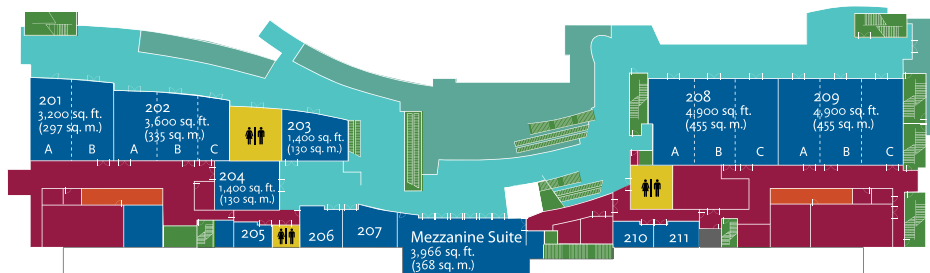
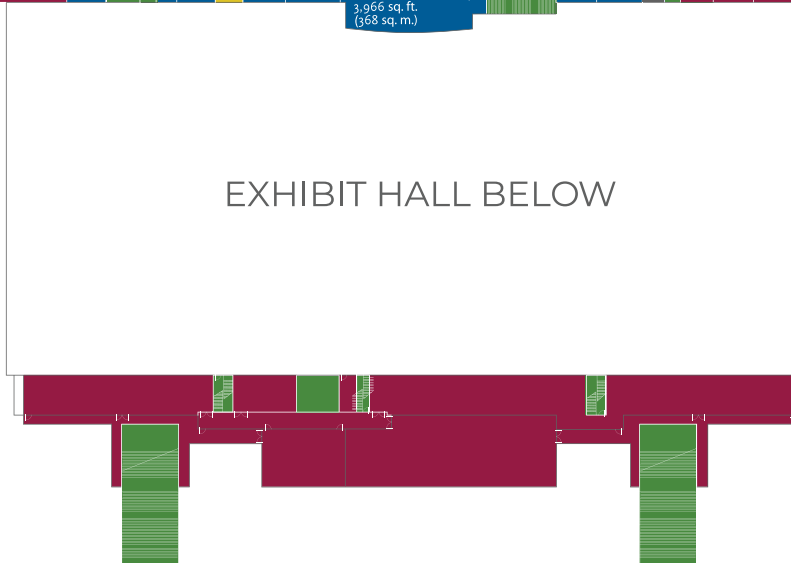

EXHIBIT HALL BELOW



MEETING SPACE

LEVEL THREE - BALLROOM

	FEET OR SQUARE FEET				METER OR SQUARE METERS				SEATING CAPACITIES			
	Area	Lenght	Width	Height	Area	Lenght	Width	Height	Theater	Banquet	Classroom	Reception
Ballroom (Total)	39,551	145	278	26-45	3,674	44.1	84.7	8-14	4,648	2,130	2,676	3,934
Ballroom A	25,563	150	170	26-45	2,375	45.7	51.8	8-14	2,340	1,320	1,710	2,450
Ballroom B	13,988	151	92	26-45	1,300	46.0	28	8-14	1,260	590	858	1,288
Terrace	12,832	203	84	-	1,192	61.9	25.6	-	-	600	-	1,200
Prefunction	22,651	-	-	-	2,104	-	-	-	-	-	-	-

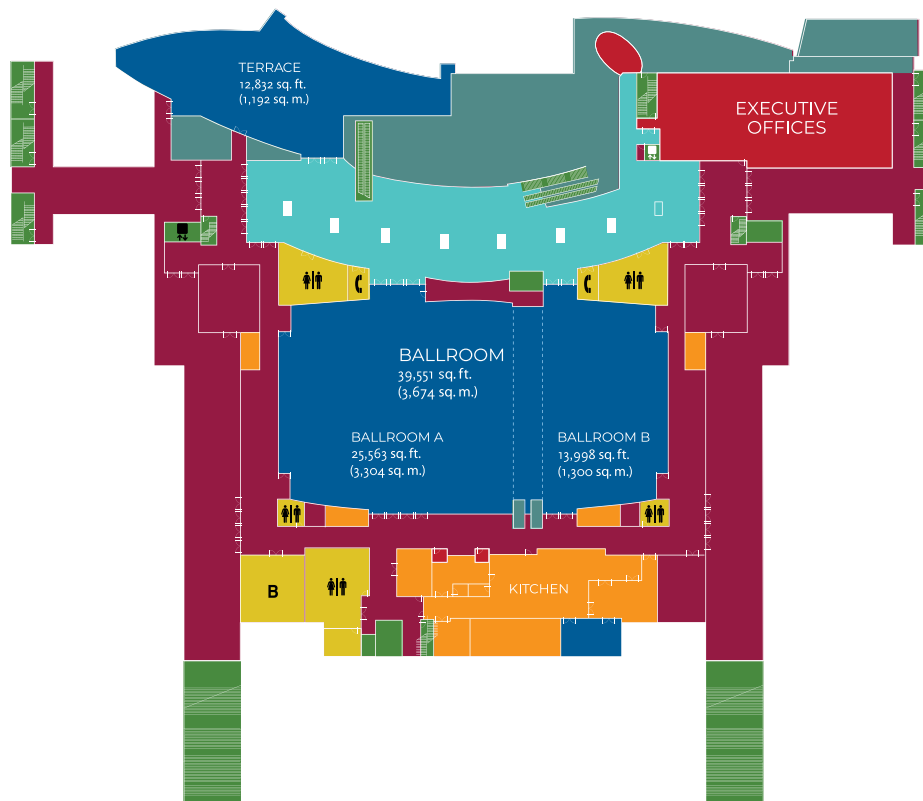

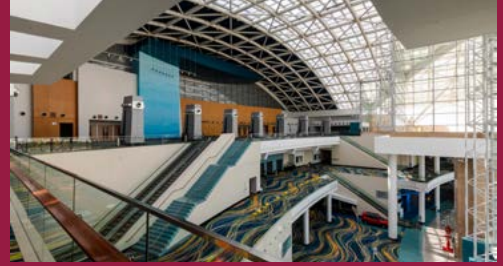

TOTAL SPACE

600,000 square feet

EXHIBIT HALL

152,700 square feet

15 MEETING ROOMS

Can be configured into 29 breakouts

LOADING DOCK

Can accommodate 22 tractor trailers

BALLROOM

39,500 square feet

VIDEO CONFERENCING

CAPABILITIES

OUTDOOR TERRACE

12,800 square feet

MEETING SPACE

36,400 square feet

BROADBAND &

WIRELESS CONNECTIVITY

200 mbps



CULTURE & ATTRACTIONS

Puerto Rico is home to:

- 3 of 5 bioluminescent bays in the world.
- One of the world's largest dry forests.
- The only rainforest in the U.S National Forest System.

189+ attractions including:

- Old San Juan Walking Tours
- Castillo San Felipe del Morro
 - Castillo San Cristobal
- Casa Bacardí Distillery Tour
 - Cueva Ventana
- Hacienda Campo Rico
 - ToroVerde
- El Yunque National Forest
- 18 Golf Courses
- 16 Casinos





TOROVERDE ADVENTURE PARK
OROCOVIS, PUERTO RICO



ROYAL ISABELA
ISABELA, PUERTO RICO

GOLF & OUTDOOR ADVENTURES



WATER SPORTS
CULEBRA, PUERTO RICO

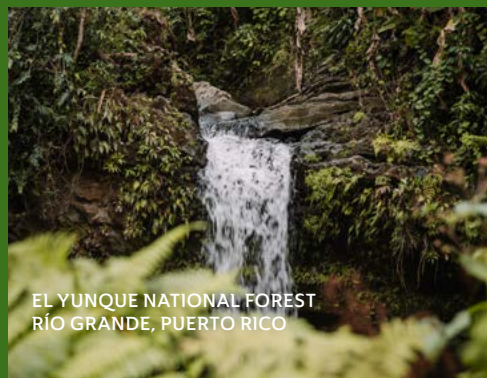

EL YUNQUE NATIONAL FOREST
RÍO GRANDE, PUERTO RICO



VENUES

Puerto Rico has a plethora of venue options ranging from coffee haciendas, historic homes and museums and even more outdoor options that will utilize our beaches, mountains and rainforest as your event backdrop. The Island is lined by nearly 300 miles of coastline, from white-sand beaches to dramatic rocky cliffs, or you can head up to the mountains, or to El Yunque rainforest for spectacular verdant views. No matter your style, budget or the size of your guest list, the possibilities for perfect venues are endless in Puerto Rico.





ANTIGUO CASINO
SAN JUAN, PUERTO RICO



DISTRITO T-MOBILE, PUERTO RICO
Photo by Max Touhey, www.metouhey.com

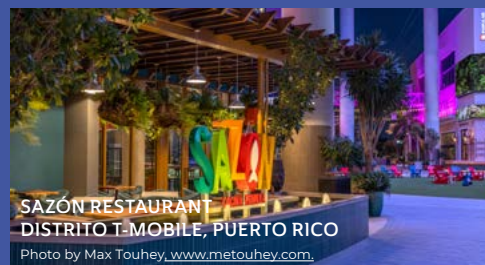

SAZÓN RESTAURANT
DISTRITO T-MOBILE, PUERTO RICO
Photo by Max Touhey, www.metouhey.com

DISTRITO T-MOBILE

Distrito T-Mobile™ is a new five-acre hospitality and entertainment district adjacent to the Puerto Rico Convention Center. This complex features an urban zipline, dayclub/nightclub, a rum micro-distillery, authentic coffee shops and numerous restaurants and bars serving authentic Puerto Rican cuisine.

A few highlights:

- Three anchors: 177-room Aloft San Juan; Caribbean Cinemas VIP “A Premium Experience,” featuring 8 premium state of the art Cinemas and Coca-Cola Music Hall, a mixed-use performance venue with space for 6K+ people, including a 900-guest VIP section, two outdoor bars and a performance stage.
- A 50,000 square ft. outdoor plaza with a digitalized stage system comprised of over 14,000 square ft of LED displays (including one of the largest horizontal displays in the U.S.).
- ToroVerde, the first permanent augmented reality zip line experience in the world.

ANTIGUO CASINO
DE
PUERTO
RICO

CONNECT WITH OUR SALES TEAM

The Discover Puerto Rico sales team will provide all the resources necessary to ensure you have a very successful event in our destination.

We recommend reaching out to our team meetings@DiscoverPuertoRico.com for assistance with the latest information on airlift, hotels, health & safety guidelines.

Find out more at DiscoverPuertoRico.com/meetings or follow our social channels at:



@MeetingsInPR



MeetingsInPR



Discover Puerto Rico



/discoverpuertorico



MIKKI WALLS

WEST & SOUTHWEST INCLUDING AK & HI, & HPN GLOBAL SALES
National Sales Director
Mobile (843) 742-1931
mikki.walls@discoverpuertorico.com



JOYCE MENDEZ

SOUTHEAST & INTERNATIONAL
National Sales Director
Mobile (407) 462-0026
joyce.mendez@discoverpuertorico.com



CAROLYN BLAKE

MIDWEST & PRESTIGE GLOBAL
National Sales Director
Mobile (305) 281-6220
carolyn.blake@discoverpuertorico.com



CARLOS DELIZ

SPORTS, ARTS & ENTERTAINMENT
Regional Sales Manager
Mobile (787) 400-0197
carlos.deliz@discoverpuertorico.com



RITA LÓPEZ CMP, HMCC

NORTHEAST
National Sales Director
Mobile (917) 406-7180
rita.lopez@discoverpuertorico.com



KIM DAROJA

Vice President of Sales
Mobile (843) 855-3957
kim.daroja@discoverpuertorico.com



YOLANDA GONZÁLEZ, DMCP, HMCC

NEW ENGLAND, CANADA & CONFERENCE DIRECT
National Sales Director
Mobile (617) 877-9417
yolanda.gonzalez@discoverpuertorico.com



FRED EDSON

Director of Incentive Sales
Mobile (561) 400-7553
fred.edson@discoverpuertorico.com



BETH BUSHMAN

MID-ATLANTIC & CONFERENCE DIRECT MID-ATLANTIC
National Sales Director
Mobile (703) 851-8835
beth.bushman@discoverpuertorico.com

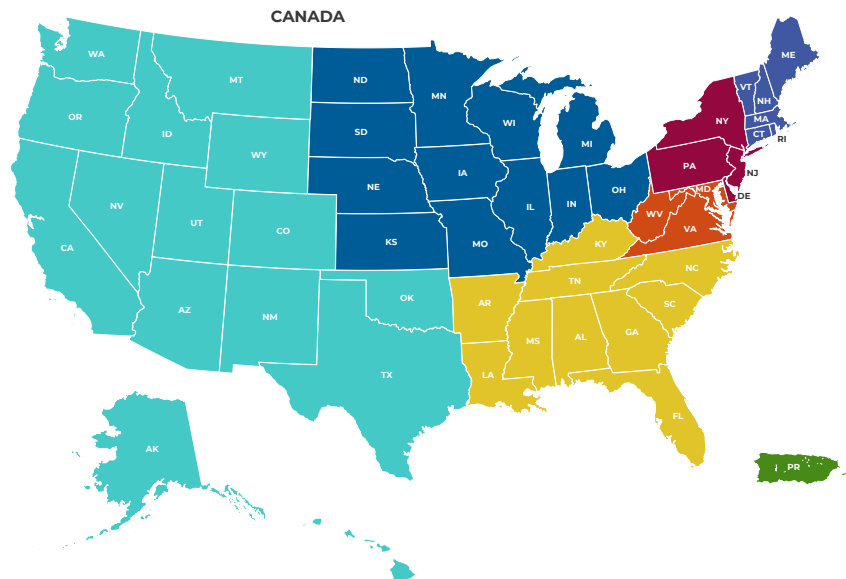



We recommend reaching out to our team meetings@DiscoverPuertoRico.com for assistance with the latest information on air, lift, hotels, health & safety guidelines:

Find out more at DiscoverPuertoRico.com/meetings or follow our social channels at:



@MeetingsInPR



MeetingsInPR



Discover Puerto Rico



/discoverpuertorico



DESTINATION SUPPORT SERVICES

Lead Service:

Our talented team of professionals have vast destination knowledge and experience. In tandem with our industry partners, we will treat your RFP with priority and provide you with the best hotel and venue options that will accommodate your group needs.

Suppliers:

We work with a database of vetted suppliers, offering a wide variety of services that will help make your event a huge success.

Site Visits:

Our Destination Site Services team will customize site inspections with properties that are a fit for your program and provide you with unique cultural experiences.

Planning Assistance:

Our Destination Support Services team can collaborate with you to schedule a successful planning visit, once your event is booked in Puerto Rico.

MARKETING SERVICES TO PROMOTE MEETINGS & INCREASE ATTENDANCE

Visual Aids:

We will provide you with unlimited photo and video assets to promote your Puerto Rico meeting. Contact Nelmeraris Baretti, Group Marketing Coordinator, at nelmeraris.baretti@discoverpuertorico.com.

Welcome Video:

We will customize a special welcome video that can be e-mailed to attendees, placed on your website or presented to your group in person to promote attendance at your future Puerto Rico event.

Marketing Toolkit:

We will provide you with unlimited photos, videos and branded promotional templates for creating postcards, e-blasts and social media to help you market your Puerto Rico event. Contact Nelmeraris Baretti, Group Marketing Coordinator, at nelmeraris.baretti@discoverpuertorico.com for more information.

ADDITIONAL SUPPORT

- We work with Rums of Puerto Rico on behalf of groups to request sponsorship or giveaway alternatives.
- We connect planners with local organizations and community outreach programs to provide options for community service projects.
- We connect planners with local associations in their industry.

DISCOVER
Puerto Rico

500 CALLE DE LA TANCA
OCHOA BUILDING, SUITE 402B
SAN JUAN, PUERTO RICO 00901, USA



@MeetingsInPR



MeetingsInPR



/discoverpuertorico



Discover Puerto Rico

DiscoverPuertoRico.com/Meetings